

# Nero® Collection



We take the worry out of  
protecting what's valuable to you.  
Lockwood: *no worries*®

**LOCKWOOD**

**ASSA ABLOY**

**25YEAR**

**MECHANICAL  
WARRANTY**

[www.assaabloy.co.nz](http://www.assaabloy.co.nz)



# NERO<sup>®</sup>

## COLLECTION



Master the Mood  
with Lockwood

*The Lockwood Nero Collection provides a sensuous  
quality that complements contemporary décor;  
adding a defining design element to any space.*



# Contents



**Entrance**  
Pull Handle  
page 4



**Velocity® Large Rose**  
Element Lever  
page 6



**Velocity® Small Rose**  
Leversets  
page 9



**Velocity® Small Rose**  
Escutcheons  
page 12



**Cavity Sliding**  
Door Lock  
page 15



**FP2**  
Flush Pull  
page 17



**724 Series**  
Slide Arm Door Closer  
page 19



**Nexion® Mechanical**  
Entrance Lockset  
page 21



**Paradigm® 005**  
Double Cylinder Deadbolt  
page 24



**Outland**  
Sliding Door Track  
page 27

# Entrance Pull Handle



The Lockwood 143/146/147 Entrance Handles are constructed using the finest materials to incorporate the maximum standards in style, durability, finish and design.

### Style and Variety

Combining fit for purpose with the epitome of style, the Lockwood Entrance Handles offer a high quality solution to the requirements of both residential and commercial markets.

### Fitting For Various Doors

Comes supplied with spigots to suit 10 – 12mm thick glass doors as well as aluminium and timber doors up to 50mm thick.

### Application

Suitable for use on timber or aluminium frame as well as glass doors; making them the ideal choice for commercial, industrial and residential applications.

**Multi Fix - timber, aluminium or glass doors**

### Product Details

#### Materials

Constructed of 304 grade stainless steel, suitable for use in external environments

### Standards and Compliance



Disabled Access - AS1428.1

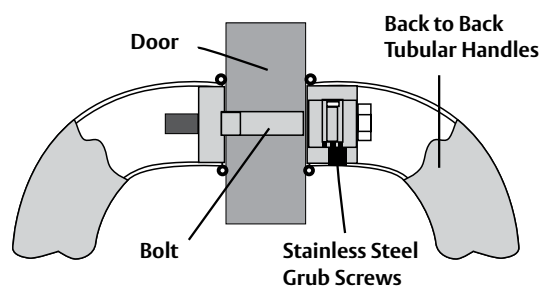

# Entrance Pull Handle

143

## Dimensions

	A	B1	B2	C	D
143x300MBK	300mm	30mm	15mm	35mm	315mm
143x450MBK	450mm	30mm	15mm	35mm	465mm
143x600MBK	600mm	30mm	15mm <td 35mm	615mm	

## Fixing

**Timber** 2 x 62mm M6 Bolts - 8.5mm hole

**Glass** 2 x 32mm M6 Bolts - 13mm hole



Disabled Accessible AS1428.1

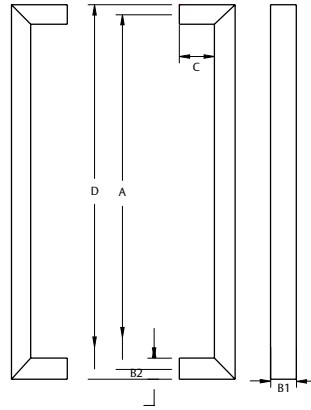

143X600MBK

146

## Dimensions

	A	B	C	D	E	F
146x450MBK	450mm	25mm	60mm	475mm	60mm	25mm
146x600MBK	600mm	25mm	60mm	625mm	60mm	25mm

## Fixing

**Timber** 2 x 80mm M8 Bolts - 8.5mm hole

**Glass** 2 x 40mm M8 Bolts - 13mm hole



Disabled Accessible AS1428.1

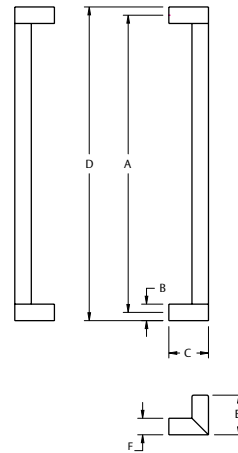

146X600MBK

147

## Dimensions

	A	B	C	D	E
147x450MBK	450mm	19mm	45mm	600mm	19mm

## Fixing

**Timber** 2 x 62mm M8 Bolts - 8.5mm hole

**Glass** 2 x 32mm M8 Bolts - 13mm hole



Disabled Accessible AS1428.1

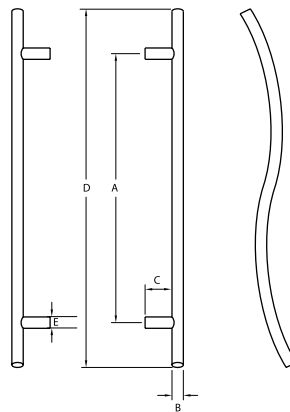

147X450MBK

# Velocity® Series Large Rose Door Furniture



The Velocity Series is a stylish range of door furniture suitable for use in residential dwellings.

Designed to suit common door preparations in the Australasian market, Velocity is ideal for both new and retrofit applications.

#### Retrofitable

Fits majority of doors with 54mm hole.

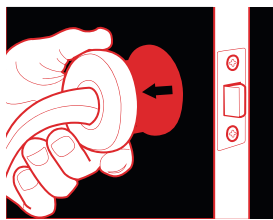

**1 Align**   **2 Twist**   **3 Tighten**



#### Features and Specifications

- All fixings are concealed beneath a removable rose trim providing a crisp and clean presentation desired by the discerning home owner
- Simple twist and tighten fixing method with pre-assembled lever set allows for super easy and fast installation
- The rose fits 50mm or 54mm diameter holes making it suitable for retrofit and common door preparations

#### Product Details

**Rose Dimensions**   63mm by 12.5mm - Round Rose  
66.5mm by 12.5mm - Square Rose

**Materials**   Solid zinc die-cast with steel rose trims

**Latches**   Passage sets are available with a 60mm backset tubular latch. Privacy sets are supplied with a 60mm backset privacy latch which includes an activating pin for the inside of the door and an external emergency release function. The latch is automatically released when the internal handle is operated and is easily adapted for both open in and open out applications. All latches are supplied with industry standard "D" strikes.

**Door Thickness**   32mm to 45mm hinged doors

**Finishes**   Matt Black (MBK)

#### Standards and Compliance

**D5**   Tested to AS4145.2 2008 for Durability passing D5 - 100,000 cycles.

 Tested to AS4145.2 2008 for Neutral Salt Spray, passing C6 - 168 hours.

Not suited to coastal applications



# Velocity® Series Large Rose Door Furniture

## Element™ – Lever 3

<b>Length</b>	122mm
<b>Projection</b>	54.5mm
<b>Finger Clearance</b>	47.5mm

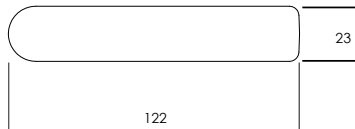
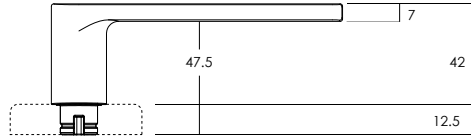

## Passage Leverset

<b>Part Number</b>	VEL1/L1MBKDP VEL1/L2MBKDP VEL1/L3MBKDP VEL1/L4MBKDP
--------------------	--

## Privacy Leverset

<b>Part Number</b>	VEL2/L1MBKDP VEL2/L2MBKDP VEL2/L3MBKDP VEL2/L4MBKDP
--------------------	--

## Dummy Lever

<b>Part Number</b>	VEL3/L1MBK VEL3/L2MBK VEL3/L3MBK VEL3/L4MBK
--------------------	--



Lever 1 - Summit®



Lever 2 - Spire®



Lever 3 - Element™



Lever 4 - Glide™

# Velocity® Series Large Rose Door Furniture

## Square Rose Passage Trim

**Part Number** VES1-TRIMMBK

\* Pack of 2

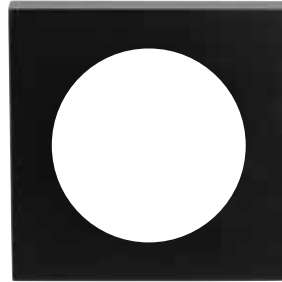

## Square Rose Privacy Trim

**Part Number** VES2-TRIMMBK

\* Pack of 2

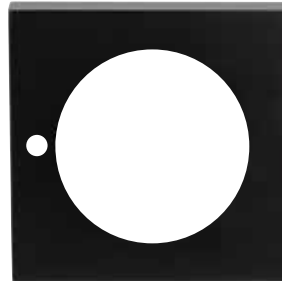

# Velocity® Series Small Rose Door Furniture



The Velocity Small Rose Series is a stylish range of door furniture suitable for both residential and semi-commercial applications. Designed primarily for new installation on timber doors, the range incorporates functionality for use with Mortice Locks in addition to Passage, Privacy and Dummy Levers.

## Installation

Suits door thickness range of 32mm to 45mm.

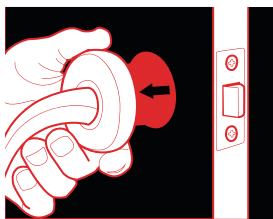

1 **Align**    2 **Twist**    3 **Tighten**



## Features and Specifications

- All fixings are concealed beneath a removable rose trim providing an aesthetically appealing installation
- Simple twist and tighten fixing method with pre-assembled lever set allows for super easy and fast installation
- Choose from two lever designs, the ever popular Element L3 lever and the AS1428.1 compliant Dianella L8 lever
- Accessories include AS1428.1 compliant turn, standard turn and privacy indicating emergency turns
- The 55mm rose suits up to 45mm door thickness commonly used with mortice locks or latches

## Product Details

**Rose Dimensions**    55mm by 12.5mm - Round Rose  
58mm by 12.5mm - Square Rose

**Materials**    Solid zinc die-cast lever with steel rose trims

**Latches**    Passage sets are available with a 60mm backset tubular latch. Privacy sets are supplied with a 60mm backset privacy latch which includes a locking pin for the inside of the door and an external emergency release function. The latch is automatically released when the internal handle is operated and is easily adapted for both open in and open out applications. All latches are supplied with industry standard "D" and "T" strikes.

**Door Thickness**    32mm to 45mm hinged doors

**Finishes**    Matt Black (MBK)

## Standards and Compliance



Successfully tested up to 2 hours on fire door assemblies in accordance with the Australian Standard AS1905.1 2005 - Part 1: Fire Resistant Doorsets when used with Lockwood Synergy or Selector mortice locks

**D8**

Tested to AS4145.2 2008 for Durability passing D8 - 500,000 cycles



Tested to AS4145.2 2008 for Neutral Salt Spray, passing C6 - 168 hours



AS1428.1 Compliance. The range includes AS1428.1 compliant levers and turns

# Velocity® Series Small Rose Door Furniture

## Element™ - Lever 3

<b>Length</b>	122mm
<b>Projection</b>	54.5mm
<b>Finger Clearance</b>	47.5mm

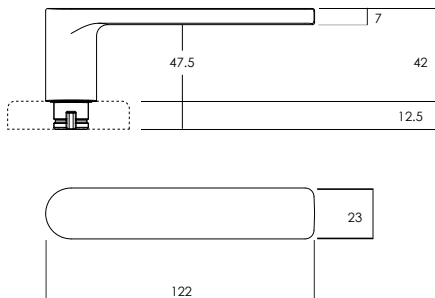

## Mortice Lock Leverset

<b>Part Number</b>	VSR0/L3MBK
--------------------	------------

## Passage Leverset

<b>Part Number</b>	VSR1/L3MBK
--------------------	------------

## Privacy Leverset

<b>Part Number</b>	VSR2/L3MBK
--------------------	------------

## Dummy Lever

<b>Part Number</b>	VSR3/L3MBK
--------------------	------------



# Velocity® Series Small Rose Door Furniture

## Dianella™ - Lever 8

**Length** 121mm

**Projection** 51mm

**Finger Clearance** 38mm



Disabled Accessible  
AS1428.1

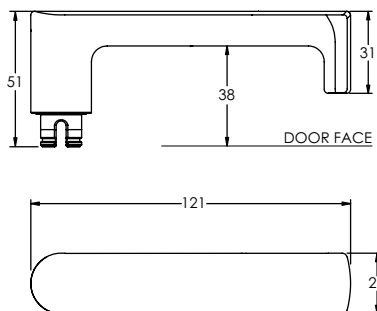

## Mortice Lock Leverset

**Part Number** VSR0/L8MBK

## Passage Leverset

**Part Number** VSR1/L8MBK

## Privacy Leverset

**Part Number** VSR2/L8MBK



# Velocity® Series Small Rose Door Furniture

## Square Rose Passage Trim

**Part Number** VSS1-TRIMMBK

\* Pack of 2

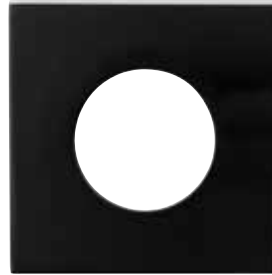

## Square Rose Privacy Trim

**Part Number** VSS2-TRIMMBK

\* Pack of 2

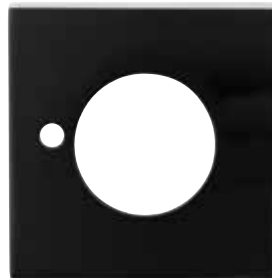

# Velocity® Series Small Rose Door Furniture

## Euro Cylinder Escutcheon

**Part Number** VSR5/MBK

**Height** 55mm

**Depth** 12.5mm

**Supplied with**  
2x Wood Screws

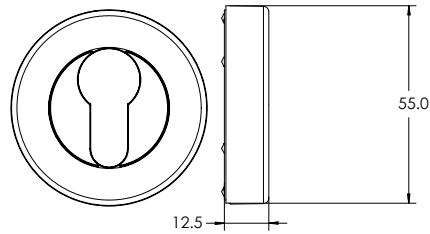

## Oval Cylinder Escutcheon

**Part Number** VSR6/MBK

**Height** 55mm

**Depth** 12.5mm

**Supplied with**  
2x Wood Screws

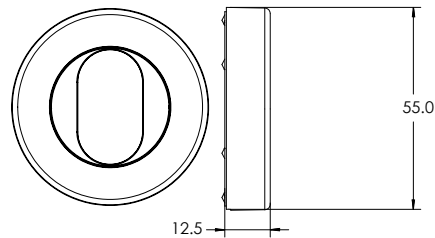

## Standard Turnknob

**Part Number** VSR7/MBK

**Height** 55mm

**Depth** 12.5mm

**Handing** Not required

**Supplied with**  
2x Wood Screws  
1x Short Tail Bar  
1x Medium Tail Bar  
1x Tail Bar Spring  
1x Instructions (1220-321)

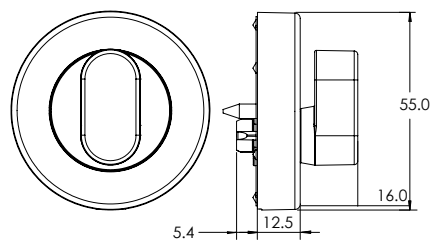

## Privacy Indicating Emergency Turn

**Part Number** VSR8/MBK

**Height** 55mm

**Depth** 12.5mm

**Supplied with**  
2x Wood Screws  
1x Emergency Tail Bar  
1x Instructions (1220-321)

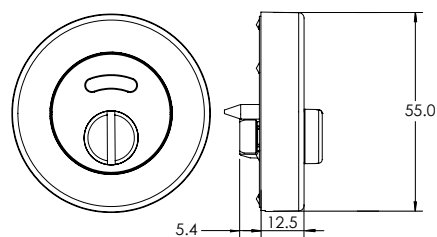

# Velocity® Series Small Rose Door Furniture

## Disabled Accessible Turnknob

**Part Number** VSR9/MBK

**Height** 55mm

**Depth** 12.5mm

**Turn Snib Length** 52mm

**Handing** Site handable

### Supplied with

- 2x Wood Screws
- 1x Tail Bar (short)
- 1x Tail Bar (medium)
- 1x Tail Bar Spring
- 1x Instructions (1220-321)

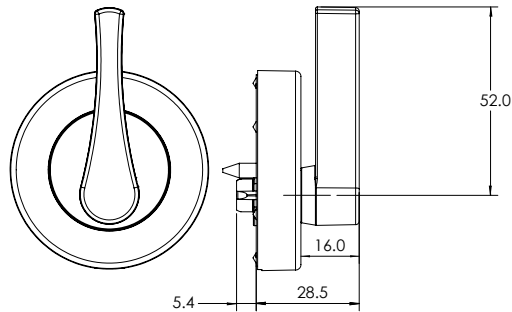

## Square Rose Escutcheon Trim

**Part Number** VSS6-TRIMMBK

\* Pack of 2

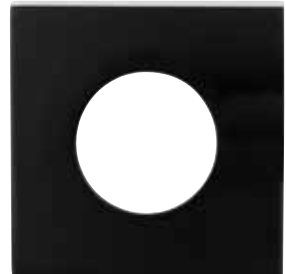



# Cavity Sliding Door Lock



The Lockwood sliding door lock range is possibly the most innovative and aesthetically pleasing lock for a cavity sliding door in Australasia. Combining elegance and ease of use, the Lockwood Cavity Sliding Door Lock range is ideal for any home décor and privacy solution.

Currently available with the privacy latch model, offering the perfect solution for residential bathroom sliding doors.

## Features and Specifications

- Fitted flush against the panel of the sliding door for full recess into the door cavity

### Retractable door pull

Designed after extensive research, the sliding cavity door lock features an innovative retractable door pull which combines style with functionality.

## Product Details

<b>Cross Drill</b>	25mm
<b>Door Thickness</b>	32* to 40mm for timber doors *Requires spacer ring (included)
<b>Finishes</b>	Matt Black (MBK)
<b>Latch Backset</b>	60mm
<b>Prep Hole</b>	54mm
<b>Strike</b>	Box strike or pip strike (passage)
<b>Materials</b>	Furniture plate: Zinc Alloy Bolt: Nickel Plated Zinc (12.4mm projection) Bolt Beak: Stainless Steel Front End Plate: Stainless Steel Retractable Door Pull: Zinc Plated Strike Plate: Stainless Steel Strike Box: Zinc Plated

# Cavity Sliding Door Lock

## 7400 Privacy Set

Part Number	Finish
7400MBKDP	Matt Black

### Outside

Emergency release button opened by coin or screwdriver

### Inside

Locked or unlocked by turn-plate

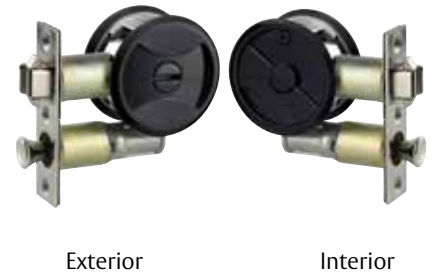
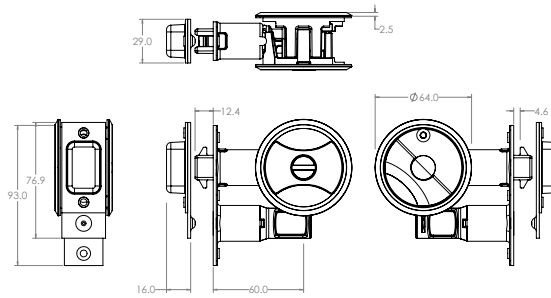

# FP2 Flush Pull



The Lockwood Nero® Flush Pull offers multiple solutions for flush mount door furniture.

## Application

Suited to numerous applications which require the door furniture to be flush with the surface of the door.

## Product Details

<b>Materials</b>	Zinc Stainless Steel
------------------	-------------------------

## Standards and Compliance

<b>C6</b>	These products have been successfully tested in accordance with AS 2331-3.1: 2001. Neutral Salt Spray Test (NSS TEST). Passing C6 Corrosion Resistance - 168 hours
-----------	--

# FP2 Flush Pull

FP2-150

Dimensions	Packaging	Part Number
------------	-----------	-------------

150 x 50mm	Trade	FP2-150MBK
------------	-------	------------

## Features and Specifications

- Stainless steel flush pull
- Trade packed, complete with fixing screws

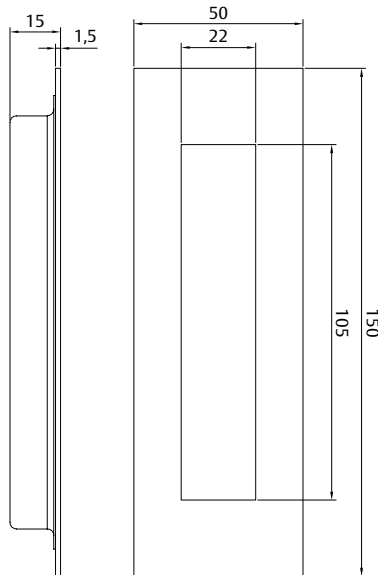

# 724 Series Slide Arm Door Closer



The Lockwood Rack & Pinion Slide Arm Series provides for a cleaner, more aesthetic appearance on the door whilst utilizing the same robust features and benefits of Rack and Pinion functionality.

## Specifications

<b>Power</b>	EN adjustable 2 to 4
<b>Back check (BC)</b>	Adjustable
<b>Hold Open</b>	Adjustable. Hold-open can be set at any angle up to 150° of opening
<b>Handing</b>	Non-handed. Suitable for left or right hand doors
<b>Cover</b>	Clip-on
<b>Materials</b>	Extruded aluminium body manufactured from high-performance silicon alloy
<b>Mechanism</b>	Rack and pinion design
<b>Mounting</b>	Regular and over-door
<b>Valves</b>	Adjustable closing and latching speed valves with overload protection.

## Standards and Compliance



Tested on fire door assemblies up to 4 hours in accordance with Australian Standard AS1905.1- 1997, Part 1: Fire Resistant Doorsets The Lockwood 724SR series closer has been successfully tested upto four hours (depending on type of doorset) on fire door assemblies in accordance with Australian Standard AS1905.1:2005, Part: Fire Resistant Door sets.

Note: Hold open option is not approved on any fire door.

# 724 Series Slide Arm Door Closer

## 724SR Slide Arm Pull Side

### Part Numbers

724SRBLK

Closer installed on pull side of door. This mounting position permits opening of 130°.

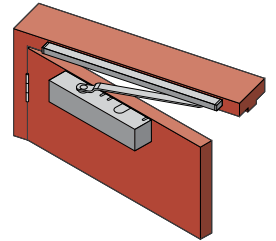
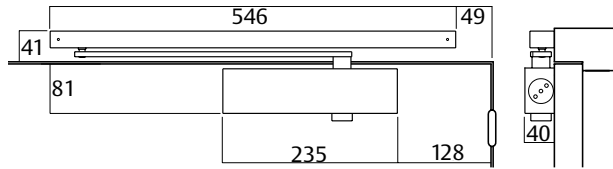

## 724SR Slide Arm Push Side

### Part Numbers

724SRBLK

Closer installed on push side of door. This mounting position permits opening of 115°.

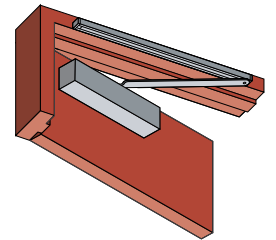
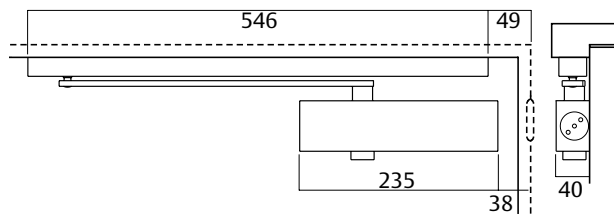

## 724SR Slide Arm Over Door Mounting Push Side

### Part Numbers

724SRBLK

Closer installed on push side of door and top rail where conditions do not allow parallel mounting. This mounting position permits opening of 115°.

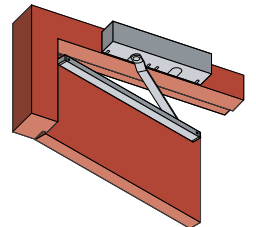
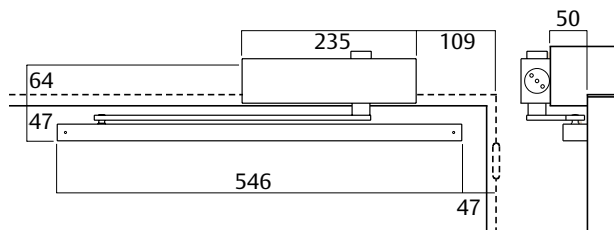

# Nexion® Mechanical Entrance Lockset



The Nexion Entrance Lockset represents the next generation in home security.

Designed and manufactured to the highest standards of quality, the Lockwood Nexion has set the benchmark for safety, security and style. The Nexion offers the ultimate protection for your home and family.

## Features and Specifications

- Three mode security: Secure, Safety and Passage mode provides excellent security without compromising convenience
- LockAlert® indicator shows lock status at a glance
- SafetyRelease™ automatically unlocks the inside handle upon entry to minimise the risk of being locked in
- High security latch
- Box strike with concealed crossgrain door frame strengthening screw
- Can be keyed alike to other Lockwood door locks as well as builder's key systems

## Product Details

<b>Backset</b>	60mm as supplied 70mm optional (order part 530-222SC)
<b>Case</b>	High purity zinc alloy
<b>Door Thickness</b>	35 to 45mm
<b>Finishes</b>	Matt Black (MBK)
<b>Handles</b>	Element Lever 3
<b>Latch</b>	13mm projection brass bolt
<b>Strike</b>	Box strike with concealed crossgrain door frame strengthening screw
<b>Templates</b>	Installation template included
<b>Handing</b>	Adjustable handing by set screw
<b>Cylinder</b>	Internal and external 5 pin tumbler mechanism with 6 pin capability Brass cylinders and brass barrels

## Standards and Compliance



The locksets can be optioned to suit fire door sets with a fire resistance level of up to 1 hour on fire door assemblies in accordance with Australian Standard AS1905.1:2005 Fire Resistant Doorsets. The fire rated option is achieved with a standard Nexion Vision Entrance Lockset and the optional fire rated kit (order NXVFRKIT).

**SL7**

(Security) Australian Lock Standard (AS4145.2.2008)

**D8**

(Durability) Australian Lock Standard (AS4145.2.2008)

**C5**

(Corrosion) Australian Lock Standard (AS4145.2.2008)



CE Approved



C-tick certified

# Nexion® Mechanical Entrance Lockset

## Keying

- Supplied individually keyed with two keys per lock
- 78,000 key combinations
- Key blank KB2015P

### Restricted Special Keying

Lockwood locks can be keyed to a number of controlled and/or specially keyed systems. These range from legally protected keys to protect against unauthorised duplication, which can also include specially designed key systems such as master key systems, which allow for different levels of mechanical access control.

Please refer to Lockwood Keying Catalogue or contact your local sales office or customer service for specific information.

## Latch Dimensions

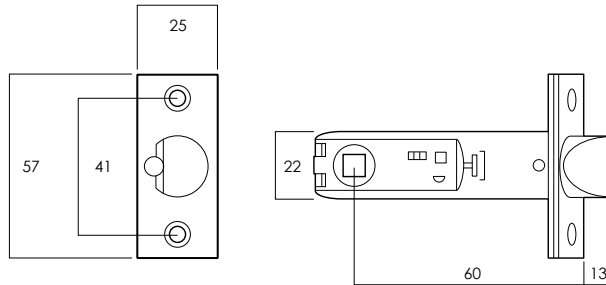

**Kinetic Defence®**  
Bump and pick resistant.



**Deadlatch Bolt**  
13mm projection  
brass bolt.



**SafetyRelease™**  
Minimises the risk of being  
locked in.



**2 Keys Included**  
Can be keyed alike to other  
Lockwood door locks.



**LockAlert®**  
Interior Indicator shows lock  
status at a glance.



**Quick Installation**  
Suitable for door thicknesses  
between 35–45mm.



**Safety Mode**  
Securely locked from outside  
and free from inside.



**Retrofittable**  
Fits majority of doors with  
54mm hole.



**Secure Mode**  
Securely locked from both  
inside and outside. For when  
nobody is home.



**Passage Mode**  
Free to enter from outside  
and free to exit from inside.





4

# Paradigm® 005 Cylinder Deadbolt



The Paradigm® 005 Double Cylinder Deadbolt is the premium security solution with its innovative safety features. The contemporary styling can be combined with any lever or entrance handle to create an elegant security solution, ideal for residential and architectural applications.

## Key Features

- Three function modes with DualSelect® provides combination of convenience and security
- High security cut resistant stainless steel bolt
- Safety Release™ automatically unlocks internal knob upon key entry from outside
- LockAlert® indicator shows lock status at a glance
- Available in round or square rose

## Restricted Special Keying

Lockwood locks can be keyed to a number of controlled and/or specially keyed systems. These range from legally protected keys to protect against unauthorised duplication, which can also include specially designed key systems such as master key systems, which allow for different levels of mechanical access control.

Please refer to Lockwood Keying Catalogue or contact your local sales office or customer service for specific information.

## Retrofittable

Replace your existing Deadbolt. Fits 54mm hole. 60-70mm adjustable backset. 32-48mm door thickness.

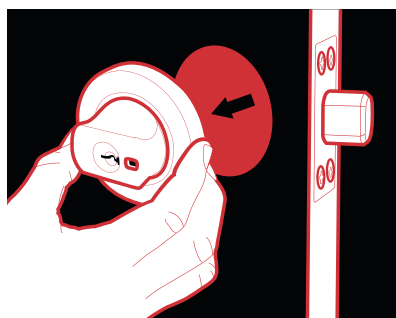

## Product Details

<b>Backset</b>	60 to 70mm adjustable stainless steel bolt
<b>Bolt</b>	High security, cut resistant stainless steel bolt
<b>Cylinder</b>	5 pin tumbler mechanism Brass cylinder and brass barrel
<b>Door Thickness</b>	32–48mm 32–36mm doors require a spacer (Included)
<b>Finishes</b>	Matt Black (MBK)
<b>Keying</b>	Supplied individually keyed with two keys per lock, 78,000 key combinations, Key blank KB2015P
<b>Materials</b>	High purity zinc alloy
<b>Strike</b>	Box strike with concealed crossgrain door frame strengthening screw

## Standards and Compliance

<b>SL8</b>	(Security) Australian Lock Standard (AS4145.2 - 2008)
<b>D8</b>	(Durability) Australian Lock Standard (AS4145.2 - 2008)
<b>C6</b>	(Corrosion) Australian Lock Standard AS4145.2 - 2008)
<b>K5</b>	(Key Security) Australian Lock Standard AS4145.2 - 2008)

# Paradigm® 005 Cylinder Deadbolt

## Round Rose



Exterior



Interior

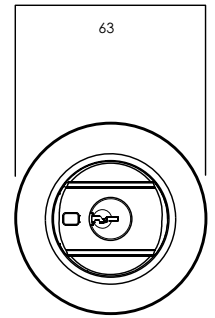
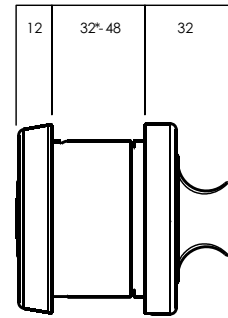
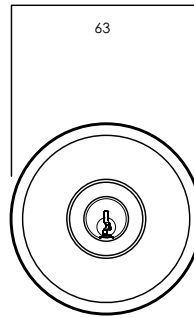

\*32–36mm door thickness requires spacer ring (included)



**Kinetic Defence®**  
Bump and pick resistant.



**Counterbalance Bolt**  
Proportionally distributes the load between the door and door frame.



**DualSelect®**  
Turn the key for safety mode. Turn the key further to select secure mode.



**2 Keys Included**  
Can be keyed alike to other Lockwood door locks.



**SafetyRelease™**  
Minimises the risk of being locked in.



**Retrofittable**  
Replace your existing Deadbolt. Fits 54mm hole. 60-70mm adjustable backset. 32-48mm door thickness.



**Anti-Corrosion**  
Successfully tested in accordance with AS2332.3.1:2001 neutral salt spray test.



**LockAlert®**  
Interior Indicator shows lock status at a glance.



**Safety Mode**  
Securely locked from outside and free from inside.



**Secure Mode**  
Securely locked from both inside and outside. For when nobody is home.



**Passage Mode**  
Free to enter from outside and free to exit from inside.

### Paradigm Deadbolt Round Rose

**Part Number** 005/B1MBKDP

# Paradigm® 005 Cylinder Deadbolt

## Square Rose



Exterior



Interior

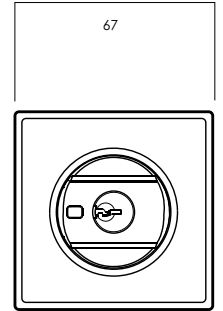
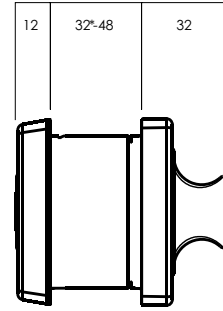
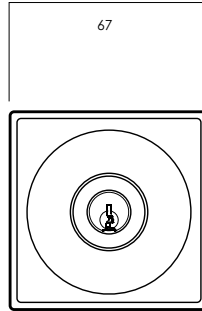

\*32–36mm door thickness requires spacer ring (included)



**Kinetic Defence®**  
Bump and pick resistant.



**Counterbalance Bolt**  
Proportionally distributes the load between the door and door frame.



**DualSelect®**  
Turn the key for safety mode. Turn the key further to select secure mode.



**2 Keys Included**  
Can be keyed alike to other Lockwood door locks.



**SafetyRelease™**  
Minimises the risk of being locked in.



**Retrofitable**  
Replace your existing Deadbolt. Fits 54mm hole. 60-70mm adjustable backset. 32-48mm door thickness.



**Anti-Corrosion**  
Successfully tested in accordance with AS2332.3.1:2001 neutral salt spray test.



**LockAlert®**  
Interior Indicator shows lock status at a glance.



**Safety Mode**  
Securely locked from outside and free from inside.



**Secure Mode**  
Securely locked from both inside and outside. For when nobody is home.



**Passage Mode**  
Free to enter from outside and free to exit from inside.

### Paradigm Deadbolt Square Rose

**Part Number** 005/B2MBKDP

# Outland Sliding Door Track



The Lockwood Outland Sliding Door Track Kit incorporates industrial design with the highest standards of quality. The Outland offers a classic barn door look with exposed steel straps that wrap beautifully around the nylon wheels; running smoothly along a flat bar track.

## Key Features

- Easy to install, perfect for DIY installations
- High quality powder coat finish provides excellent durability
- Quiet operation with nylon bearing wheels

## Product Details

<b>Material</b>	Steel
<b>Door Material</b>	Timber
<b>Door Thickness</b>	35-45mm
<b>Max Door Weight</b>	80kg
<b>Max Door Width</b>	2m Kit - 1000mm 3m Kit - 1500mm
<b>Finish</b>	Black Powder Coat
<b>Application</b>	Internal doors only Two kits required for double door installation
<b>Fixing</b>	Outland track kits include fixing screws to suit masonry walls, as well as plasterboard walls, with timber support structures Tracks are pre-drilled with 450mm hole centres

# Outland Sliding Door Track

## Outland Sliding Door Track Kits

Part Number	Description
OTL2000BLK	2m Track and Hardware Kit
OTL3000BLK	3m Track and Hardware Kit

### Kits include:

Description	2m	3m
Track (2m or 3m)	x1	x1
Track wall spacers	x5	x7
Hangers	x2	x2
Door Stops	x2	x2
Floor guide	x1	x1
Anti-jump discs	x2	x2

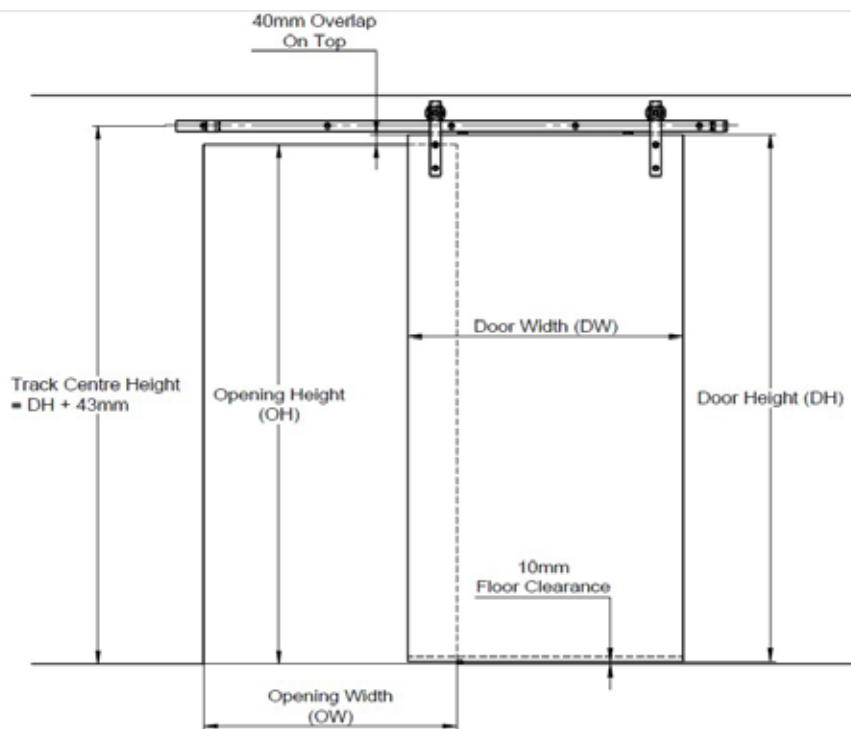
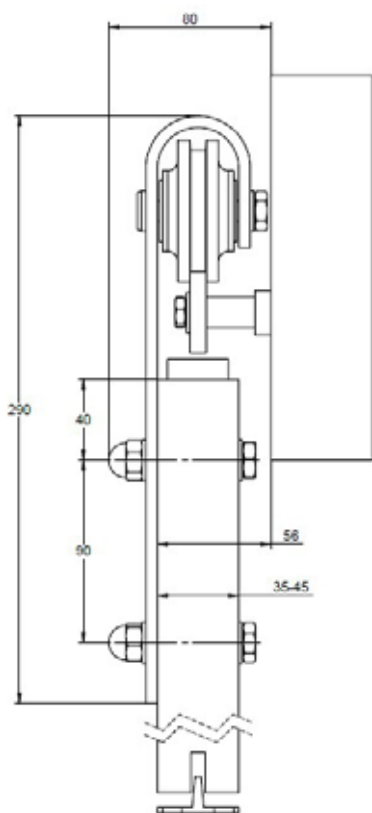

Door Width (DW) = OW + (2\*40mm)

Door Height (DH) = OH + 40mm Overlap on top - 10mm Floor Clearance





**ASSA ABLOY**

**Lockwood** is the leading brand in the Australasian locking industry. With an established reputation for high quality products, this iconic brand provides a wide range of locking solutions to residential housing, commercial, semi-commercial, building and industrial application markets. Lockwood is supported by an extensive distribution and after-sales support network. Our customers include retailers, architects, trade and industrial personnel, locksmiths and security dealers.

**ASSA ABLOY**

**ASSA ABLOY** is the global leader in door opening solutions, dedicated to satisfying end-user needs for security, safety and convenience.

**ASSA ABLOY** is represented in all major regions, in both mature and emerging markets, with leading positions in New Zealand, Australia, Europe and North America.

As the world's leading lock group, **ASSA ABLOY** offers a more complete product range of door opening solutions than any other company in the market.

**25YEAR  
MECHANICAL  
WARRANTY**

For full details of Lockwood Warranties, please visit [www.assaabloy.co.nz/warranties](http://www.assaabloy.co.nz/warranties)

**ASSA ABLOY New Zealand Ltd**  
6 Armstrong Road  
Albany, Auckland, 0632  
New Zealand

**nzsales@assaabloy.com**  
Telephone +64 9 448 9188  
[assaabloy.co.nz](http://assaabloy.co.nz)

